

# SS.FE.DSS

## STAINLESS STEEL FEMALE DOUBLE SWIVEL SHACKLE

METRIC THREADS

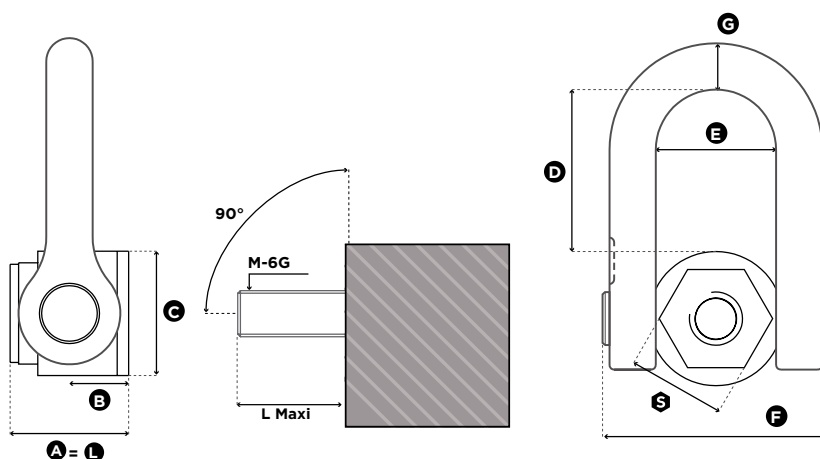

1 in = 25.4 mm

Reference	Diameter	SF 5:1 WLL (t)	SF 4:1 WLL (t)	L Maxi (mm)	Torque (Nm)	S (mm)	A (mm)	B (mm)	C (mm)	D (mm)	E (mm)	F (mm)	G (mm)	Weight (kg)
SS.FE.DSS M 24	M 24 (x3)	2,70	2,70	66	160	50	66	31	70	98	73	149	30	5,8
SS.FE.DSS M 30	M 30 (x3,5)	3,50	3,50	66	250	50	66	31	70	98	73	149	30	5,8
SS.FE.DSS M 33	M 33 (x3,5)	3,50	3,50	66	250	50	66	31	70	98	73	149	30	5,8
SS.FE.DSS M 36	M 36 (x4)	5,00	5,00	66	320	50	66	31	70	98	73	149	30	5,8

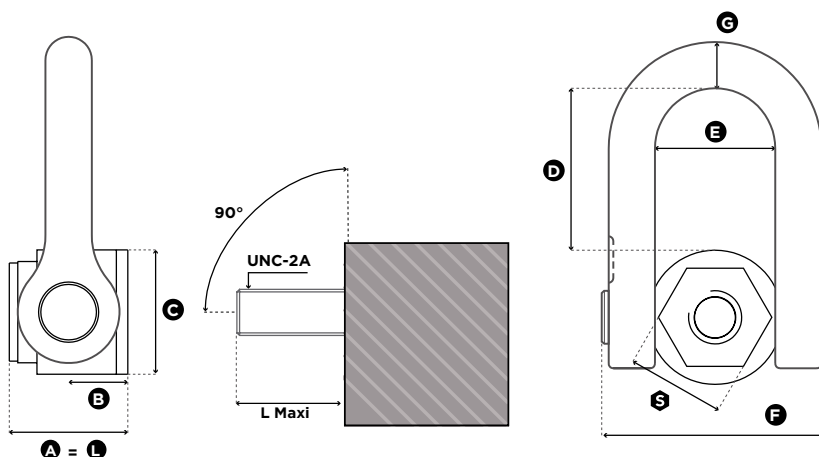
**SS.FE.DSS****STAINLESS STEEL  
FEMALE DOUBLE SWIVEL SHACKLE****UNC THREADS**

1 in = 25.4 mm

Reference	Diameter	SF 5:1 WLL (lbs)	SF 4:1 WLL (lbs)	L Maxi (mm)	Torque (Nm)	S (mm)	A (mm)	B (mm)	C (mm)	D (mm)	E (mm)	F (mm)	G (mm)	Weight (kg)
<b>SS.FE.DSS U 100</b>	UNC 1"-8	<b>6,000</b>	<b>6,000*</b>	66	125	50	66	31	70	98	73	149	30	5,4
<b>SS.FE.DSS U 125</b>	UNC 1" 1/4-7	<b>7,500</b>	<b>7,500*</b>	66	200	50	66	31	70	98	73	149	30	5,4
<b>SS.FE.DSS U 138</b>	UNC 1" 3/8-6	<b>7,500</b>	<b>7,500*</b>	66	240	50	66	31	70	98	73	149	30	5,4
<b>SS.FE.DSS U 150</b>	UNC 1" 1/2-6	<b>11,000</b>	<b>11,000*</b>	89	240	60	89	38	95	123	91	182	41	12,0

\* In certification process / En cours d'homologation / In Entwicklungsphase / En proceso de homologación

03.2020

# SS.DSS

## STAINLESS STEEL DOUBLE SWIVEL SHACKLE

METRIC THREADS

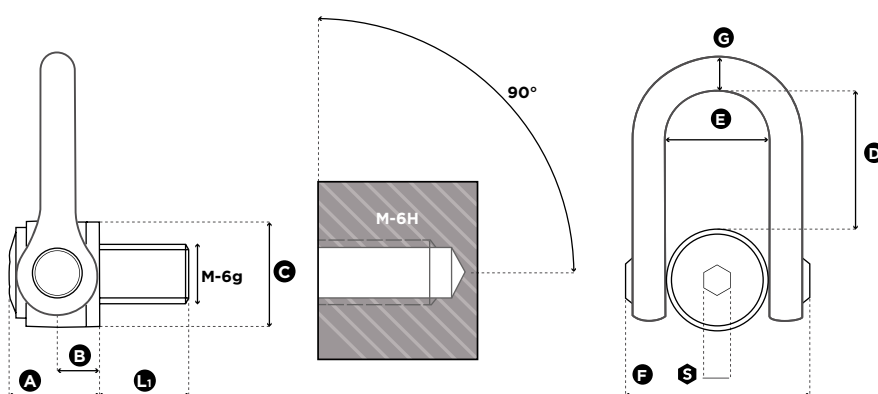

1 in = 25.4 mm

Reference	Diameter	SF 5:1 WLL (t)	SF 4:1 WLL (t)	Standard L1 (mm)	Torque (Nm)	S (mm)	A (mm)	B (mm)	C (mm)	D (mm)	E (mm)	F (mm)	G (mm)	Weight (kg)
SS.DSS M 24	M 24 (x3)	2,70	2,70*	36	160	19	61	31	70	98	73	149	30	5,2
SS.DSS M 30	M 30 (x3,5)	3,50	3,50*	45	250	19	61	31	70	98	73	149	30	5,2
SS.DSS M 33	M 33 (x3,5)	3,50	3,50*	50	250	19	61	31	70	98	73	149	30	5,2
SS.DSS M 36	M 36 (x4)	5,00	5,00*	54	320	19	61	31	70	98	73	149	30	5,2
SS.DSS M 36x3	M 36 (x3)	5,00	5,00*	54	320	19	61	31	70	98	73	149	30	5,2
SS.DSS M 39	M 39 (x4)	5,00	5,00*	54	320	19	61	31	70	98	73	149	30	5,4
SS.DSS M 42	M 42 (x4,5)	6,00	6,00*	63	400	19	61	31	70	98	73	149	30	5,4
SS.DSS M 42x3	M 42 (x3)	6,00	6,00*	63	400	19	61	31	70	98	73	149	30	5,4
SS.DSS M 45	M 45 (x4,5)	/ *	6,00	63	400	19	61	31	70	98	73	149	30	5,7
SS.DSS M 48	M 48 (x5)	/ *	6,40	68	600	19	79	38	90	123	91	182	41	11,0
SS.DSS M 48x3	M 48 (x3)	/ *	6,40	68	600	19	79	38	90	123	91	182	41	11,0
SS.DSS M 48x4	M 48 (x4)	/ *	6,40	68	600	19	79	38	90	123	91	182	41	11,0
SS.DSS M 52	M 52 (x5)	/ *	6,40	68	600	19	79	38	90	123	91	182	41	11,2
SS.DSS M 56	M 56 (x5,5)	/ *	8,00	78	600	19	79	38	90	123	91	182	41	11,3
SS.DSS M 56x4	M 56 (x4)	/ *	8,00	78	600	19	79	38	90	123	91	182	41	11,4

\* In certification process / En cours d'homologation / In Entwicklungsphase / En proceso de homologación

# SS.DSS

## STAINLESS STEEL DOUBLE SWIVEL SHACKLE

UNC THREADS

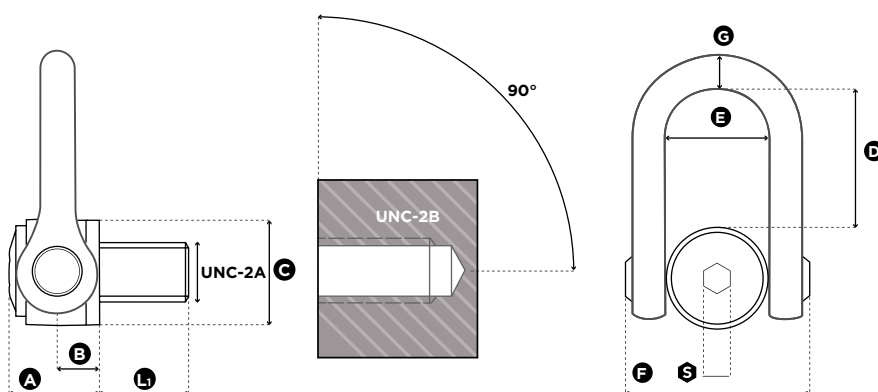

1 in = 25.4 mm

Reference	Diameter	SF 5:1 WLL (lbs)	SF 4:1 WLL (lbs)	Standard L1 (mm)	Torque (ft-lb)	S (mm)	A (mm)	B (mm)	C (mm)	D (mm)	E (mm)	F (mm)	G (mm)	Weight (kg)
SS.DSS U 100	UNC 1"-8	6,000	6,000*	40	125	3/4"	61	31	70	98	73	149	30	5,2
SS.DSS U 125	UNC 1" 1/4-7	7,500	7,500*	45	200	3/4"	61	31	70	98	73	149	30	5,2
SS.DSS U 138	UNC 1" 3/8-6	7,500	7,500*	54	240	3/4"	61	31	70	98	73	149	30	5,2
SS.DSS U 150	UNC 1" 1/2-6	11,000	11,000*	61	240	3/4"	61	31	70	98	73	149	30	5,4
SS.DSS U 200	UNC 2" 4,5	/ *	14,000	76	450	3/4"	79	38	90	123	91	182	41	11,1

\* In certification process / En cours d'homologation / In Entwicklungsphase / En proceso de homologación

# SS.DSS / SS.FE.DSS



## LOAD ANGLE CHART

$\beta_{\max} : 60^\circ$   
L : Load

4:1

### METRIC THREADS

Torque  
(Nm)



Number of rings		1	2	1	2	2			3 → 4		
Lifting angle $\beta$		0°	0°	90°	90°	0° → 45°	46° → 60°	Asymmetric	0° → 45°	46° → 60°	Asymmetric
SS.DSS M 24 / SS.FE.DSS M 24	160	2,70*	5,40*	2,70*	5,40*	3,78*	2,70*	2,70*	5,67*	2,70*	2,70*
SS.DSS M 30 / SS.FE.DSS M 30	250	3,50*	7,00*	3,50*	7,00*	4,90*	3,50*	3,50*	7,35*	3,50*	3,50*
SS.DSS M 33 / SS.FE.DSS M 33	250	3,50*	7,00*	3,50*	7,00*	4,90*	3,50*	3,50*	7,35*	3,50*	3,50*
SS.DSS M 36 / SS.FE.DSS M 36	320	5,00*	10,00*	5,00*	10,00*	7,00*	5,00*	5,00*	10,50*	5,00*	5,00*
SS.DSS M 36x3	320	5,00*	10,00*	5,00*	10,00*	7,00*	5,00*	5,00*	10,50*	5,00*	5,00*
SS.DSS M 39	320	5,00*	10,00*	5,00*	10,00*	7,00*	5,00*	5,00*	10,50*	5,00*	5,00*
SS.DSS M 42	400	6,00*	12,00*	6,00*	12,00*	8,40*	6,00*	6,00*	12,60*	6,00*	6,00*
SS.DSS M 42x3	400	6,00*	12,00*	6,00*	12,00*	8,40*	6,00*	6,00*	12,60*	6,00*	6,00*
SS.DSS M 45	400	6,00	12,00	6,00	12,00	8,40	6,00	6,00	12,60	6,00	6,00
SS.DSS M 48	600	6,40	12,80	6,40	12,80	8,96	6,40	6,40	13,44	6,40	6,40
SS.DSS M 48x3	600	6,40	12,80	6,40	12,80	8,96	6,40	6,40	13,44	6,40	6,40
SS.DSS M 48x4	600	6,40	12,80	6,40	12,80	8,96	6,40	6,40	13,44	6,40	6,40
SS.DSS M 52	600	6,40	12,80	6,40	12,80	8,96	6,40	6,40	13,44	6,40	6,40
SS.DSS M 56	600	8,00	16,00	8,00	16,00	11,20	8,00	8,00	16,80	8,00	8,00
SS.DSS M 56x4	600	8,00	16,00	8,00	16,00	11,20	8,00	8,00	16,80	8,00	8,00

max. load in t

\* In certification process with higher WLL / En cours d'homologation avec CMU plus élevée / In Entwicklungsphase mit höheren Tragfähigkeitswerten / En proceso de homologación con una CMU más elevada

4:1

### UNC THREADS

Torque  
(ft-lb)



Number of rings		1	2	1	2	2			3 → 4		
Lifting angle $\beta$		0°	0°	90°	90°	0° → 45°	46° → 60°	Asymmetric	0° → 45°	46° → 60°	Asymmetric
SS.DSS U 100 / SS.FE.DSS U 100	125	6,000*	12,000*	6,000*	12,000*	8,400*	6,000*	6,000*	12,600*	6,000*	6,000*
SS.DSS U 125 / SS.FE.DSS U 125	200	7,500*	15,000*	7,500*	15,000*	10,500*	7,500*	7,500*	15,750*	7,500*	7,500*
SS.DSS U 138 / SS.FE.DSS U 138	240	7,500*	15,000*	7,500*	15,000*	10,500*	7,500*	7,500*	15,750*	7,500*	7,500*
SS.DSS U 150 / SS.FE.DSS U 150	240	11,000*	22,000*	11,000*	22,000*	15,400*	11,000*	11,000*	23,100*	11,000*	11,000*
SS.DSS U 200	450	14,000	28,000	14,000	28,000	19,600	14,000	14,000	29,400	14,000	14,000

max. load in lbs

\* In certification process with higher WLL / En cours d'homologation avec CMU plus élevée / In Entwicklungsphase mit höheren Tragfähigkeitswerten / En proceso de homologación con una CMU más elevada

# SS.DSS / SS.FE.DSS



## LOAD ANGLE CHART

$\beta_{\max} : 60^\circ$   
L : Load

5:1

METRIC THREADS		Torque (Nm)										
Number of rings			1	2	1	2	2			3 → 4		
Lifting angle $\beta$			0°	0°	90°	90°	0° → 45°	46° → 60°	Asymmetric	0° → 45°	46° → 60°	Asymmetric
SS.DSS M 24 / SS.FE.DSS M 24	160		2,70	5,40	2,70	5,40	3,78	2,70	2,70	5,67	2,70	2,70
SS.DSS M 30 / SS.FE.DSS M 30	250		3,50	7,00	3,50	7,00	4,90	3,50	3,50	7,35	3,50	3,50
SS.DSS M 33 / SS.FE.DSS M 33	250		3,50	7,00	3,50	7,00	4,90	3,50	3,50	7,35	3,50	3,50
SS.DSS M 36 / SS.FE.DSS M 36	320		5,00	10,00	5,00	10,00	7,00	5,00	5,00	10,50	5,00	5,00
SS.DSS M 36X3	320		5,00	10,00	5,00	10,00	7,00	5,00	5,00	10,50	5,00	5,00
SS.DSS M 39	320		5,00	10,00	5,00	10,00	7,00	5,00	5,00	10,50	5,00	5,00
SS.DSS M 42	400		6,00	12,00	6,00	12,00	8,40	6,00	6,00	12,60	6,00	6,00
SS.DSS M 42x3	400		6,00	12,00	6,00	12,00	8,40	6,00	6,00	12,60	6,00	6,00

max. load in t

5:1

UNC THREADS		Torque (ft-lb)										
Number of rings			1	2	1	2	2			3 → 4		
Lifting angle $\beta$			0°	0°	90°	90°	0° → 45°	46° → 60°	Asymmetric	0° → 45°	46° → 60°	Asymmetric
SS.DSS U 100 / SS.FE.DSS U 100	125		6,000	12,000	6,000	12,000	8,400	6,000	6,000	12,600	6,000	6,000
SS.DSS U 125 / SS.FE.DSS U 125	200		7,500	15,000	7,500	15,000	10,500	7,500	7,500	15,750	7,500	7,500
SS.DSS U 138 / SS.FE.DSS U 138	240		7,500	15,000	7,500	15,000	10,500	7,500	7,500	15,750	7,500	7,500
SS.DSS U 150 / SS.FE.DSS U 150	240		11,000	22,000	11,000	22,000	15,400	11,000	11,000	23,100	11,000	11,000

max. load in lbs